

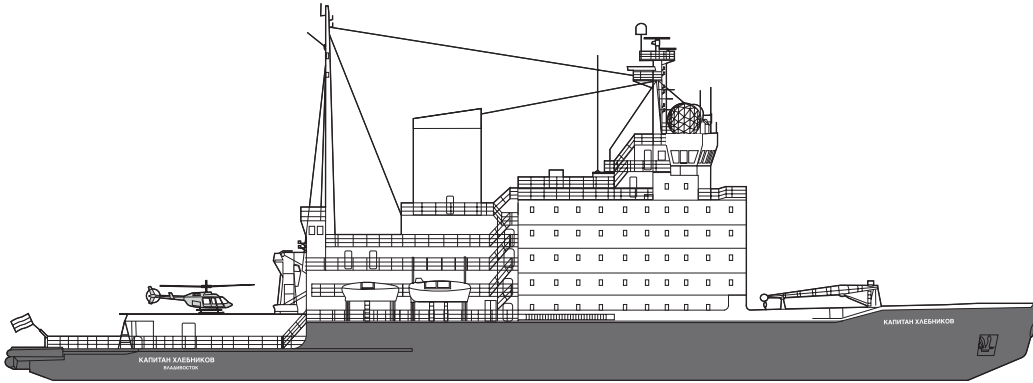

# DECK PLAN

## I/B Kapitan Khlebnikov



- \_\_\_\_\_ RADIO DECK
- \_\_\_\_\_ BRIDGE
- \_\_\_\_\_ DECK 8
- \_\_\_\_\_ DECK 7
- \_\_\_\_\_ DECK 6
- \_\_\_\_\_ DECK 5
- \_\_\_\_\_ DECK 4
- \_\_\_\_\_ DECK 3

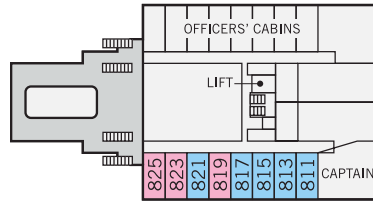

**Deck 8**

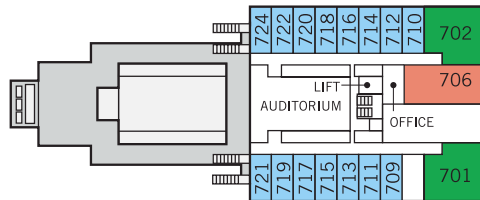

**Deck 7**

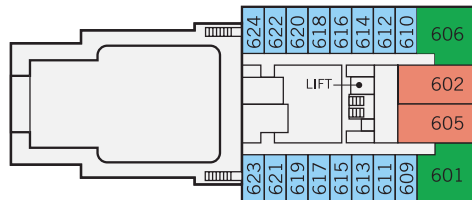

**Deck 6**

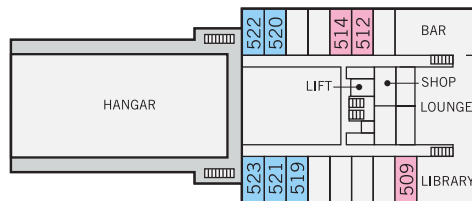

**Deck 5**

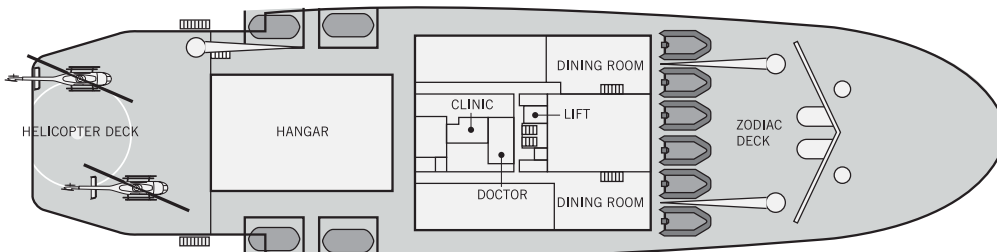

**Deck 4**

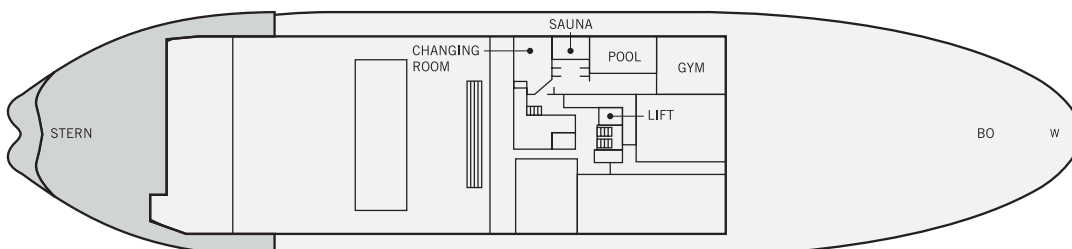

**Deck 3**

I/B Kapitan Khlebnikov  
**CORNER SUITE**  
**Deck 7, 6**  
 CABIN LAYOUT

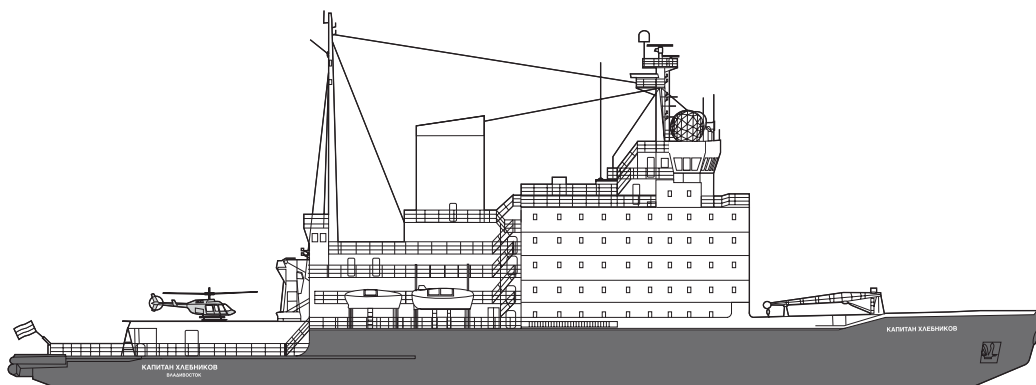

- \_\_\_\_\_ RADIO DECK
- \_\_\_\_\_ BRIDGE
- \_\_\_\_\_ DECK 8
- \_\_\_\_\_ DECK 7
- \_\_\_\_\_ DECK 6
- \_\_\_\_\_ DECK 5
- \_\_\_\_\_ DECK 4
- \_\_\_\_\_ DECK 3

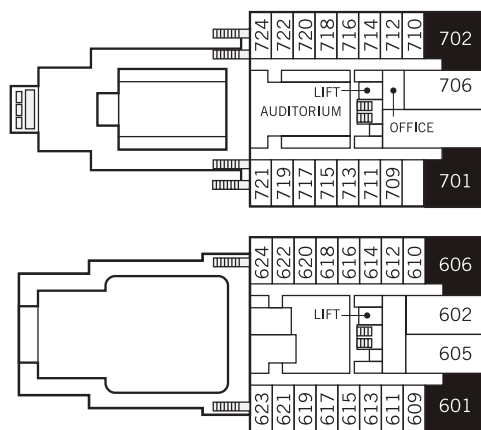

**Deck 7**

**Deck 6**

# I/B Kapitan Khlebnikov CORNER SUITE CABIN LAYOUT

Cabin:  
702  
701  
Deck 7

Cabin #: 702 and 701 (side-inverted)

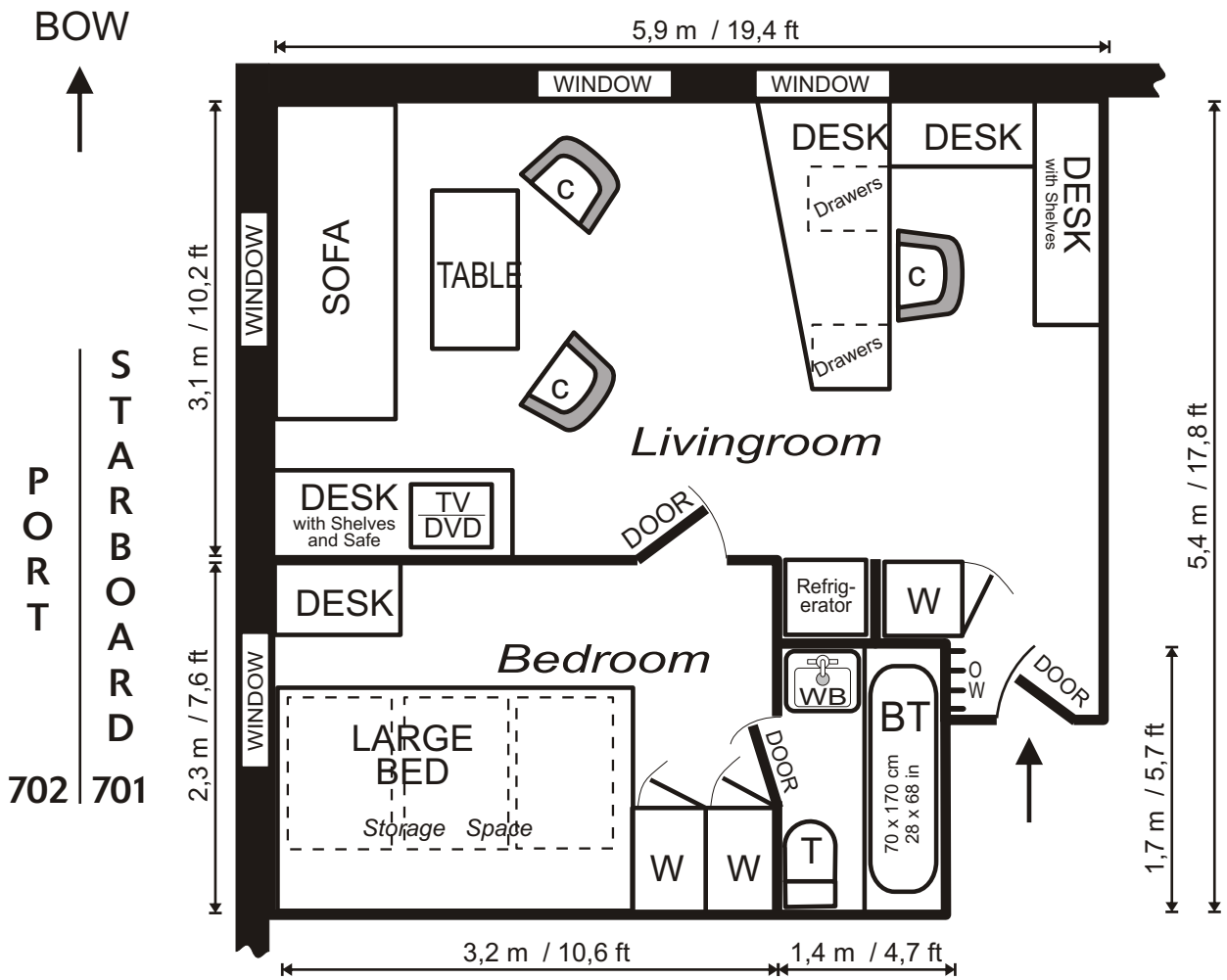

## Signs & Symbols

W ..... Wardrobe (Hangers, Shelves)	C ..... Chair	BT ..... Bathtub
OW ..... Open Wardrobe (Hangers)	T ..... Toilet (Vacuum System)	WB ..... Wash Basin

### Cabin:

- Multi TV and DVD Player
- Refrigerator
- Telephone
- Air Ventilation
- 3 Windows (2 Front, 1 Side) - to be opened
- Mirror (ca. 50 x 130 cm / 20 x 51 inch)
- Floor - Carpet
- Writing Desk / Chair
- Electrical Outlets (European) 220 Volt / 50 Hz
- Open Wardrobe (Hooks only)
- Shelving for Books, Drawers, etc...
- Sofa Bed (1,95 x 1,15 m / 6.2 x 3.6 ft)
- Safe

### Bedroom:

- Bed (2,0 x 1,3 m / 6,6 x 4,3 ft)
- 2 Wardrobes (Hangers, Shelves)
- 1 Window (to be opened)
- Small Desk with Chair
- Floor - Carpet
- Telephone

### Bathroom:

- Bathtub
- Shelf
- Electrical Outlet for Shaver (220V)
- Washbasin
- Vanity hanger
- Toilet (Vacuum System)
- Basket
- Hooks
- Mirror (ca. 60 x 40 cm / 24 x 16 inch)

### Sizes:

Total:	30,0 m <sup>2</sup> / 322,9 ft <sup>2</sup>
Size of Livingroom:	20,2 m <sup>2</sup> / 217,4 ft <sup>2</sup>
Bedroom:	7,4 m <sup>2</sup> / 79,7 ft <sup>2</sup>
Bathroom:	2,4 m <sup>2</sup> / 25,8 ft <sup>2</sup>
Height of Cabin:	2,1 m / 6,9 ft

PLEASE NOTE: This drawing is not to scale and is intended as a general indication of the cabin layout. There may be some variation subject to deck and location. Measurements from Wall to Wall. Layout is subject to change by the owner. Sofa & Bed in separate Rooms!

# I/B Kapitan Khlebnikov CORNER SUITE CABIN LAYOUT

Cabin:  
**606**  
**601**  
Deck 6

Cabin #: 606 and 601 (side-inverted)

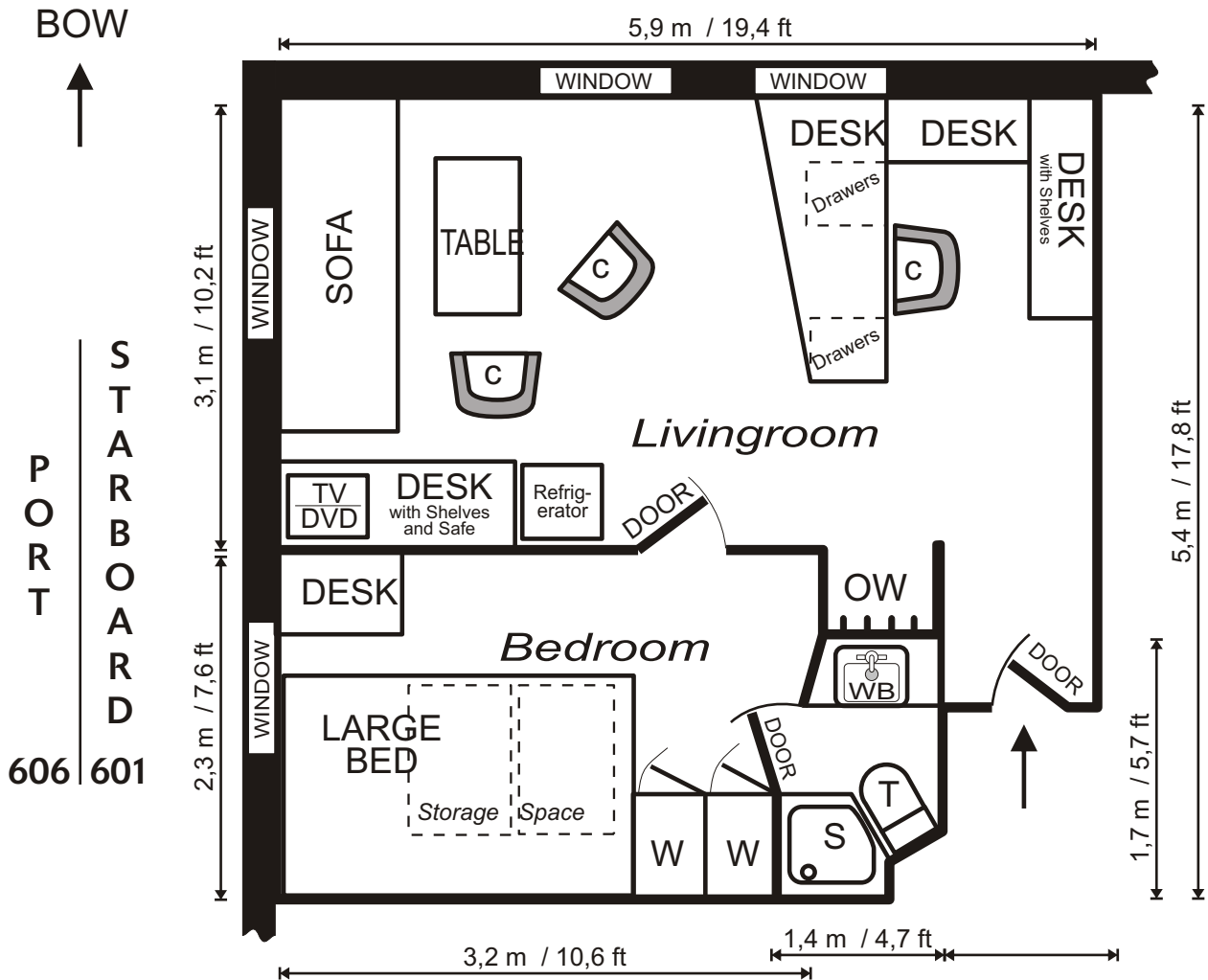

## Signs & Symbols

W ..... Wardrobe (Hangers, Shelves)  
OW ..... Open Wardrobe (Hangers)

C ..... Chair  
T ..... Toilet (Vacuum System)

S ..... Shower  
WB ..... Wash Basin

## Cabin:

Multi TV and DVD Player  
Refrigerator  
Telephone  
Air Ventilation  
3 Windows (2 Front, 1 Side) - to be opened  
Mirror (ca. 50 x 130 cm / 20 x 51 inch)  
Floor - Carpet  
Writing Desk / Chair  
Electrical Outlets (European) 220 Volt / 50 Hz  
Open Wardrobe (Hooks only)  
Shelving for Books, Drawers, etc...  
Sofa Bed (1,95 x 1,15 m / 6.2 x 3.6 ft)  
Safe

## Bedroom:

Bed (2,0 x 1,3 m / 6,6 x 4,3 ft)  
2 Wardrobes (Hangers, Shelves)  
1 Window (to be opened)  
Small Desk with Chair  
Floor - Carpet

Telephone

## Bathroom:

Shower Shelf Toilet (Vacuum System)  
Washbasin Vanity hanger  
Basket Hooks  
Mirror (ca. 60 x 40 cm / 24 x 16 inch)

## Sizes:

Total:	30,0 m <sup>2</sup> / 322,9 ft <sup>2</sup>
Size of Livingroom:	20,7 m <sup>2</sup> / 222,8 ft <sup>2</sup>
Bedroom:	7,1 m <sup>2</sup> / 76,4 ft <sup>2</sup>
Bathroom:	2,2 m <sup>2</sup> / 23,7 ft <sup>2</sup>
Height of Cabin:	2,1 m / 6,9 ft

**PLEASE NOTE:** This drawing is not to scale and is intended as a general indication of the cabin layout. There may be some variation subject to deck and location. Measurements from Wall to Wall. Layout is subject to change by the owner.  
Sofa & Bed in separate Rooms!

# I/B Kapitan Khlebnikov

## SUITE TWIN

### Deck 7, 6

#### CABIN LAYOUT

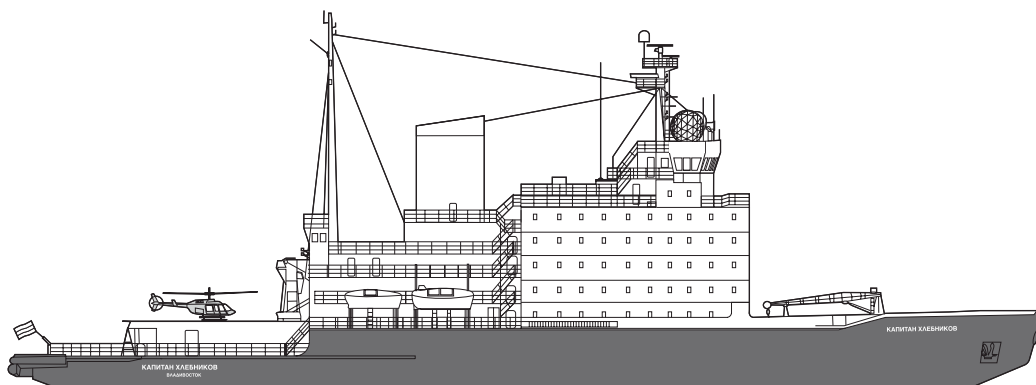

- \_\_\_\_\_ RADIO DECK
- \_\_\_\_\_ BRIDGE
- \_\_\_\_\_ DECK 8
- \_\_\_\_\_ DECK 7
- \_\_\_\_\_ DECK 6
- \_\_\_\_\_ DECK 5
- \_\_\_\_\_ DECK 4
- \_\_\_\_\_ DECK 3

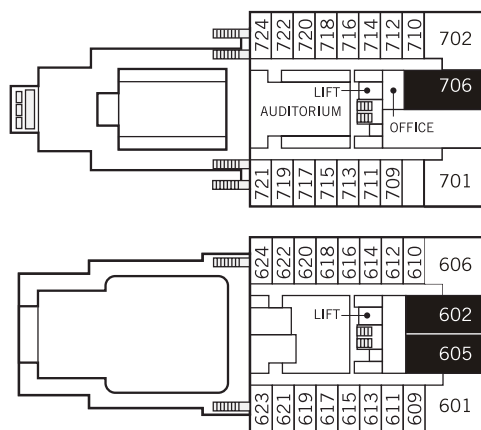

**Deck 7**

**Deck 6**

# I/B Kapitan Khlebnikov

## SUITE TWIN

### CABIN LAYOUT

Cabin:  
602, 605  
706  
Deck 6, 7

Cabin #: 602, 706 and 605 (side-inverted)

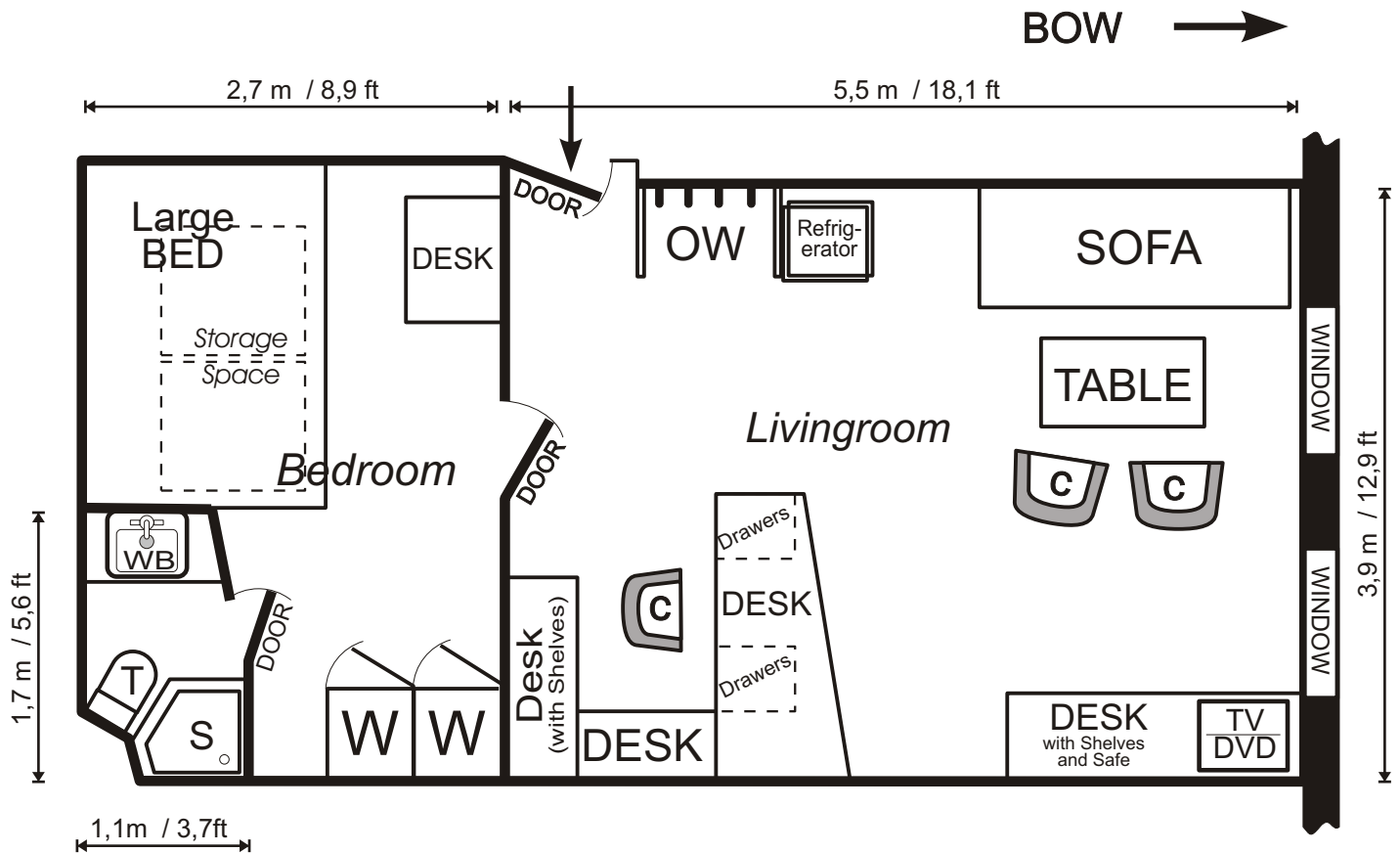

### Signs & Symbols

W ..... Wardrobe (Hangers, Shelves)  
 OW ..... Open Wardrobe (Hangers)

C ..... Chair  
 T ..... Toilet (Vacuum System)

S ..... Shower  
 WB ..... Wash Basin

### Cabin:

Multi TV and DVD Player  
 Refrigerator  
 Telephone  
 Air Ventilation  
 2 Windows (Front) - to be opened  
 Mirror (ca. 50 x 130 cm / 20 x 51 inch)  
 Floor - Carpet  
 Writing Desk / Chair  
 Electrical Outlets (European) 220 Volt / 50 Hz  
 Open Wardrobe (Hooks only)  
 Shelving for Books, Drawers, etc...  
 Sofa Bed (2,0 x 1,1 m / 6.2 x 3.6 ft)  
 1 Storage Box (height: 60 cm / 24 inch)  
 Safe

### Bedroom:

Bed (2,0 x 1,3 m / 6,6 x 4,3 ft)  
 2 Wardrobes (Hangers, Shelves)  
 Small Desk with Chair  
 Floor - Carpet  
 Telephone

### Bathroom:

Shower Shelf Electrical Outlet for Shaver (220V)  
 Washbasin Vanity hanger Toilet (Vacuum System)  
 Basket Hooks  
 Mirror (ca. 60 x 40 cm / 24 x 16 inch)

### Sizes:

Total:	32,2 m <sup>2</sup> / 346,6 ft <sup>2</sup>
Size of Livingroom:	21,6 m <sup>2</sup> / 232,5 ft <sup>2</sup>
Bedroom:	8,7 m <sup>2</sup> / 93,6 ft <sup>2</sup>
Bathroom:	1,9 m <sup>2</sup> / 20,5 ft <sup>2</sup>
Height of Cabin:	2,1 m / 6,9 ft

**PLEASE NOTE:** This drawing is not to scale and is intended as a general indication of the cabin layout. There may be some variation subject to deck and location. Measurements from Wall to Wall. Layout is subject to change by the owner.  
**Sofa & Bed in seperate Rooms !**

# I/B Kapitan Khlebnikov

# STANDARD TWIN

## Deck 5 - 8

### CABIN LAYOUT

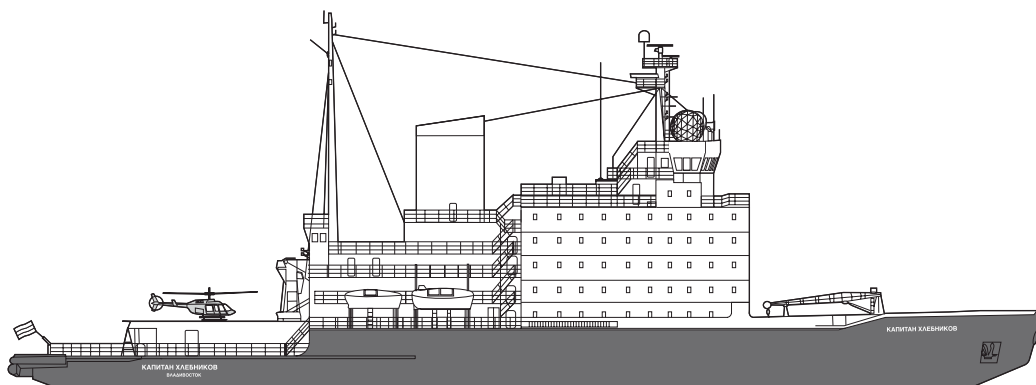

- \_\_\_\_\_ RADIO DECK
- \_\_\_\_\_ BRIDGE
- \_\_\_\_\_ DECK 8
- \_\_\_\_\_ DECK 7
- \_\_\_\_\_ DECK 6
- \_\_\_\_\_ DECK 5
- \_\_\_\_\_ DECK 4
- \_\_\_\_\_ DECK 3

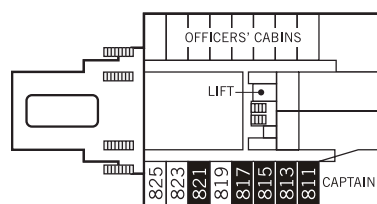

**Deck 8**

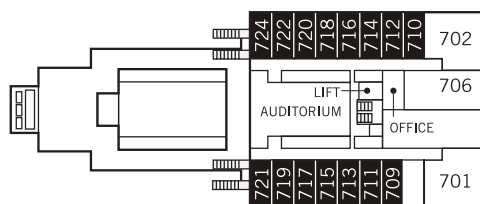

**Deck 7**

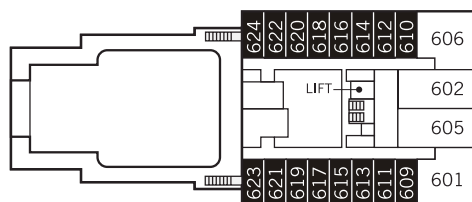

**Deck 6**

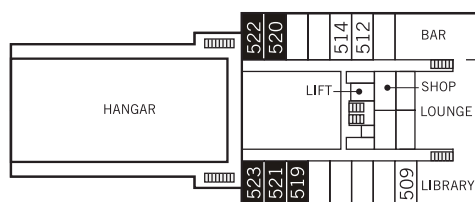

**Deck 5**

# I/B Kapitan Khlebnikov

## STANDARD TWIN

### CABIN LAYOUT

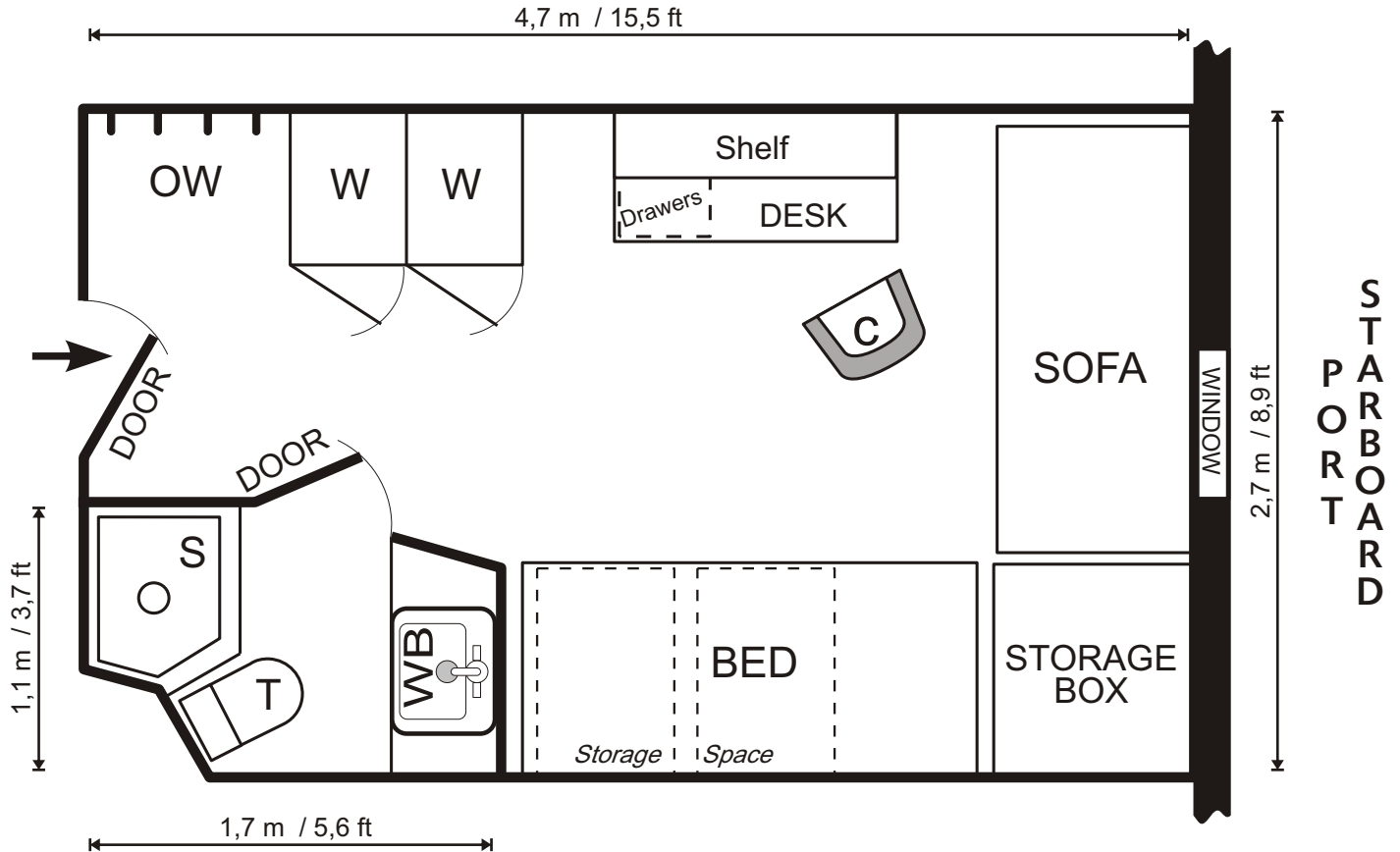

### Signs & Symbols

W ..... Wardrobe (Hangers, Shelves)  
OW ..... Open Wardrobe (Hangers)

C ..... Chair  
T ..... Toilet (Vacuum System)

S ..... Shower  
WB ..... Wash Basin

### Cabin:

Telephone  
Air Ventilation  
1 Window (Side) - to be opened  
Mirror (ca. 60 x 40 cm / 24 x 16 inch)  
Floor - Carpet  
Writing Desk / Chair  
Electrical Outlets (European) 220 Volt / 50 Hz  
Open Wardrobe (Hooks only)  
2 Wardrobes (Hangers, Shelves)  
Shelving for Books, Drawers, etc..  
1 Storage Box (height: 60 cm / 24 inch)  
Sofa Bed (1,85 x 1,1 m / 6.0 x 3.6 ft)  
Bed (2,0 x 0,8 m / 6,6 x 3,0 ft)

### Bathroom:

Shower      Shelf      Electrical Outlet for Shaver (220V/50Hz)  
Washbasin      Hooks      Toilet (Vacuum System)  
Basket  
Mirror (ca. 60 x 40 cm / 24 x 16 inch)

### Sizes:

	Total:	12,5 m <sup>2</sup> / 138,2 ft <sup>2</sup>
Size of Cabin:		10,6 m <sup>2</sup> / 114,1 ft <sup>2</sup>
Bathroom:		1,9 m <sup>2</sup> / 20,7 ft <sup>2</sup>
Height of Cabin:		2,1 m / 6,9 ft

**PLEASE NOTE:** This drawing is not to scale and is intended as a general indication of the cabin layout. There may be some variation subject to deck and location. Measurements from Wall to Wall. Layout is subject to change by the owner.

I/B Kapitan Khlebnikov  
**STANDARD TRIPLE**  
**Deck 5, 8**  
 CABIN LAYOUT

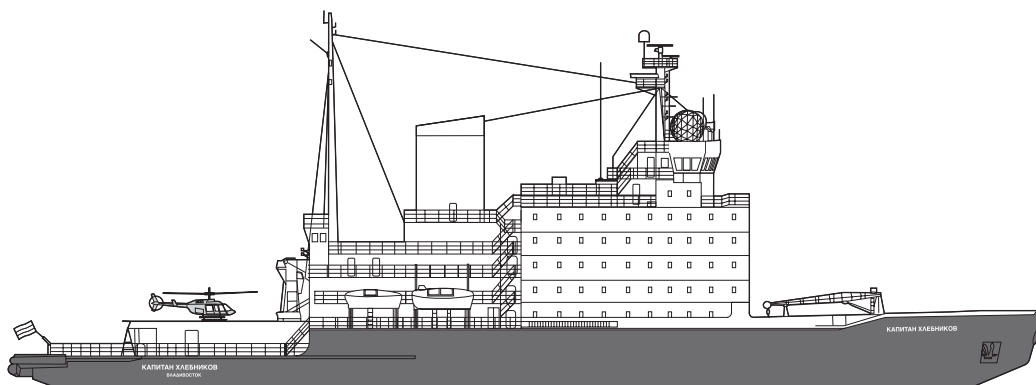

- \_\_\_\_\_ RADIO DECK
- \_\_\_\_\_ BRIDGE
- \_\_\_\_\_ DECK 8
- \_\_\_\_\_ DECK 7
- \_\_\_\_\_ DECK 6
- \_\_\_\_\_ DECK 5
- \_\_\_\_\_ DECK 4
- \_\_\_\_\_ DECK 3

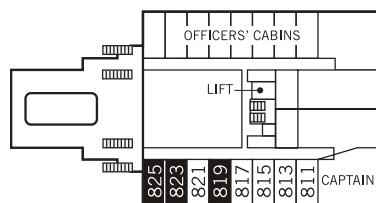

**Deck 8**

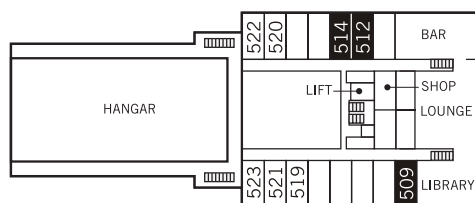

**Deck 5**

# I/B Kapitan Khlebnikov

## STANDARD TRIPLE

### CABIN LAYOUT

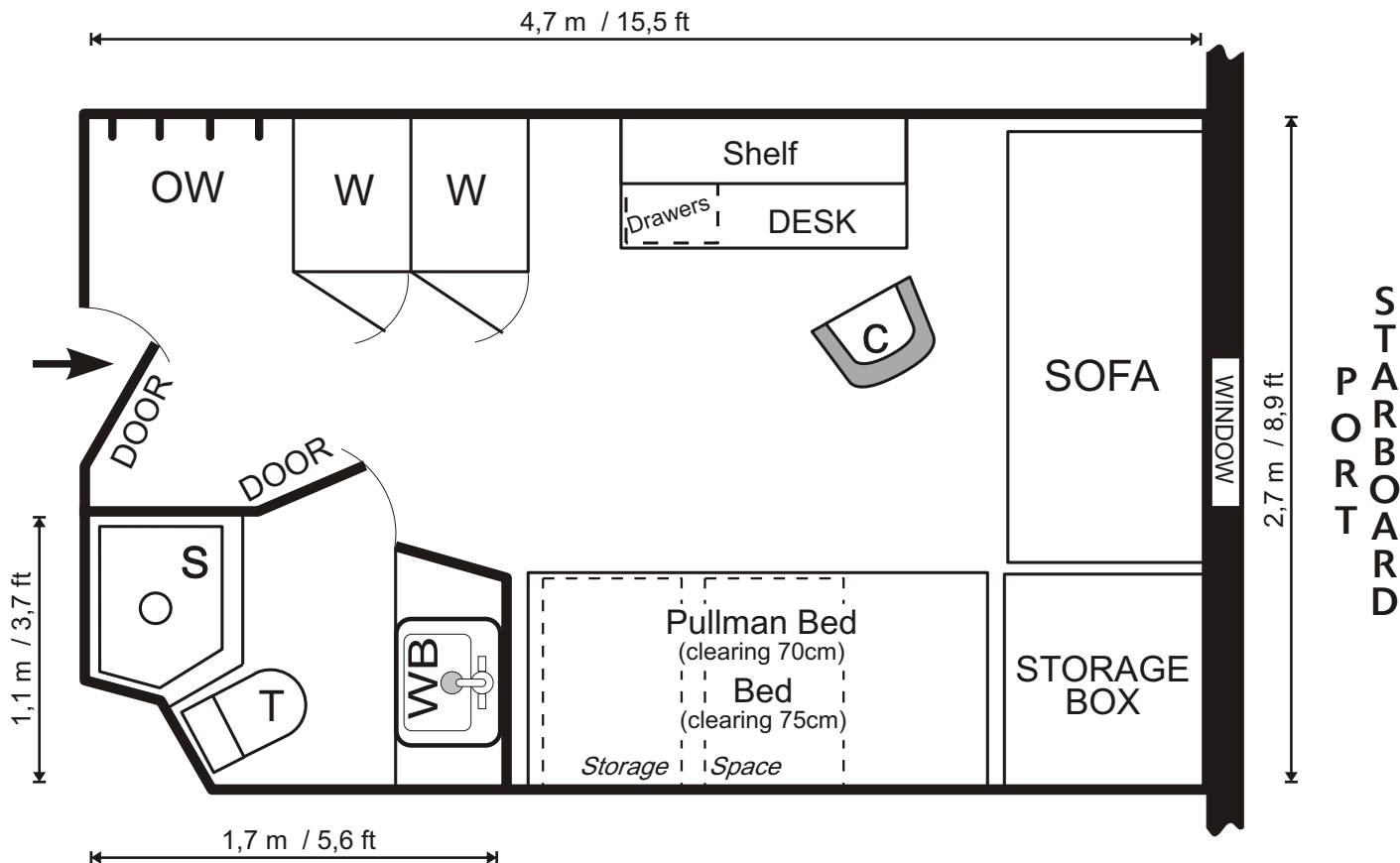

### Signs & Symbols

W ..... Wardrobe (Hangers, Shelves)  
 OW ..... Open Wardrobe (Hangers)

C ..... Chair  
 T ..... Toilet (Vacuum System)

S ..... Shower  
 WB ..... Wash Basin

### Cabin:

Telephone  
 Air Ventilation  
 1 Window (Side) - to be opened  
 Mirror (ca. 50 x 130 cm / 20 x 51 inch)  
 Floor - Carpet  
 Writing Desk / Chair  
 Electrical Outlets (European) 220 Volt / 50 Hz  
 Open Wardrobe (Hooks only)  
 2 Wardrobes (Hangers, Shelves)  
 Shelving for Books, Drawers, etc...  
 1 Storage Box (height: 60 cm / 24 inch)  
 Sofa Bed (1,85 x 1,1 m / 6.0 x 3.6 ft)  
 Bed (2,0 x 0,8 m / 6,6 x 3,0 ft)  
 Pullman Bed (2,0 x 0,8 m / 6,6 x 3,0 ft) (Located above Bed)

### Bathroom:

Shower      Shelf      Electrical Outlet for Shaver (220V/50Hz)  
 Washbasin      Hooks      Toilet (Vacuum System)  
 Basket  
 Mirror (ca. 60 x 40 cm / 24 x 16 inch)

### Sizes:

	Total:	12,5 m <sup>2</sup> / 138,2 ft <sup>2</sup>
Size of Cabin:	10,6 m <sup>2</sup> / 114,1 ft <sup>2</sup>	
Bathroom:	1,9 m <sup>2</sup> / 20,7 ft <sup>2</sup>	
Height of Cabin:	2,1 m / 6,9 ft	

**PLEASE NOTE:** This drawing is not to scale and is intended as a general indication of the cabin layout. There may be some variation subject to deck and location. Measurements from Wall to Wall. Layout is subject to change by the owner.

**I/B Kapitan Khlebnikov**

# **CORNER SUITE**

**3D - CABIN LAYOUT**

I/B Kapitan Khlebnikov  
**CORNER SUITE**  
3D - CABIN LAYOUT



**PLEASE NOTE:** This drawing is not to scale and is intended as a general indication of the cabin layout. There may be some variation subject to deck and location. Layout is subject to change by the owner.

© 07/2007 by team-graf.at / CabinPlansKL07.cdr / Design by Global Design - B. Graf - AUSTRIA

**I/B Kapitan Khlebnikov**

# **SUITE TWIN**

**3D - CABIN LAYOUT**

I/B Kapitan Khlebnikov  
**SUITE TWIN**  
3D - CABIN LAYOUT



**PLEASE NOTE:** This drawing is not to scale and is intended as a general indication of the cabin layout. There may be some variation subject to deck and location. Layout is subject to change by the owner.

**I/B Kapitan Khlebnikov**

# **STANDARD TWIN**

3D - CABIN LAYOUT

I/B Kapitan Khlebnikov  
**STANDARD TWIN**  
3D - CABIN LAYOUT

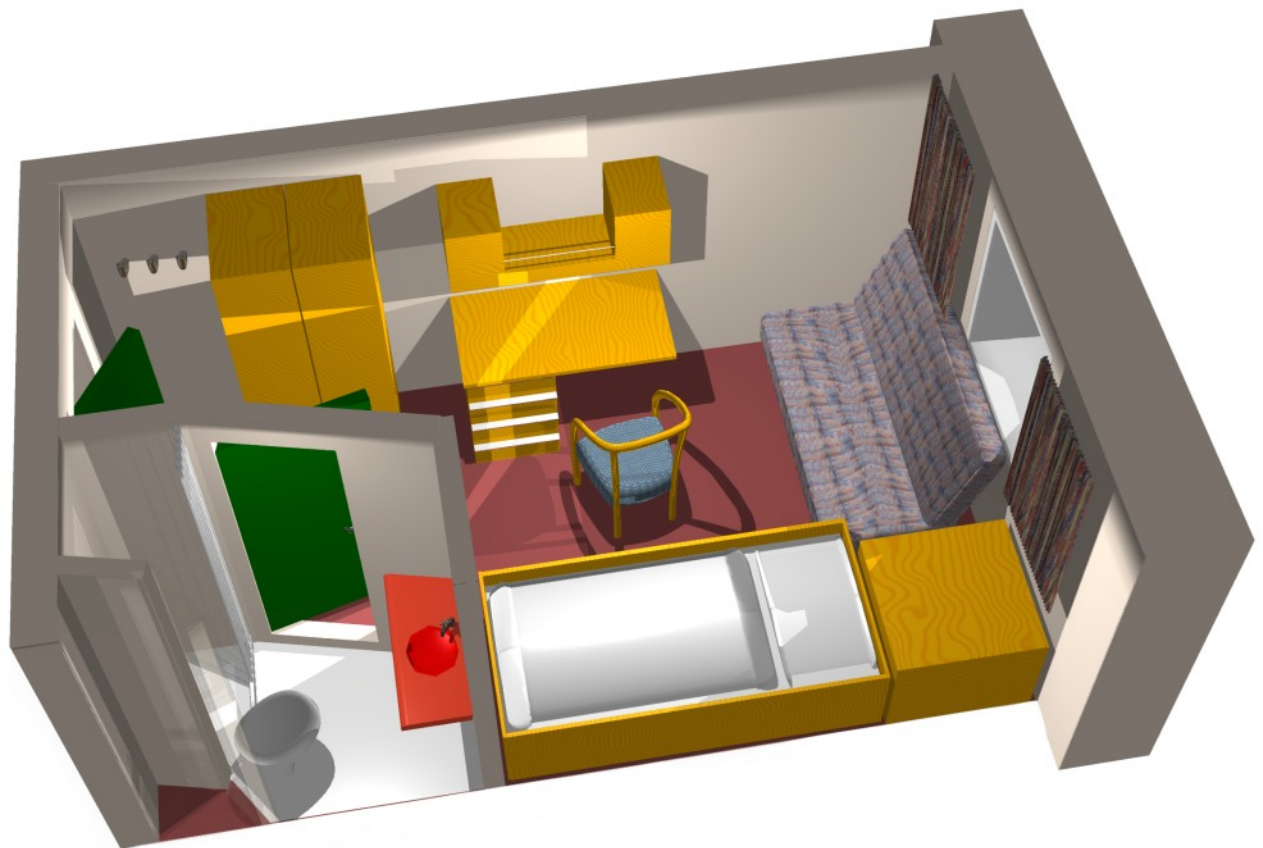

**PLEASE NOTE:** This drawing is not to scale and is intended as a general indication of the cabin layout. There may be some variation subject to deck and location. Layout is subject to change by the owner.

© 07/2007 by team-graf.at / CabinPlansKLB07.cdr / Design by Global Design - B. Graf - AUSTRIA

**I/B Kapitan Khlebnikov**

# **STANDARD TRIPLE**

3D - CABIN LAYOUT

I/B Kapitan Khlebnikov  
**STANDARD TRIPLE**  
3D - CABIN LAYOUT

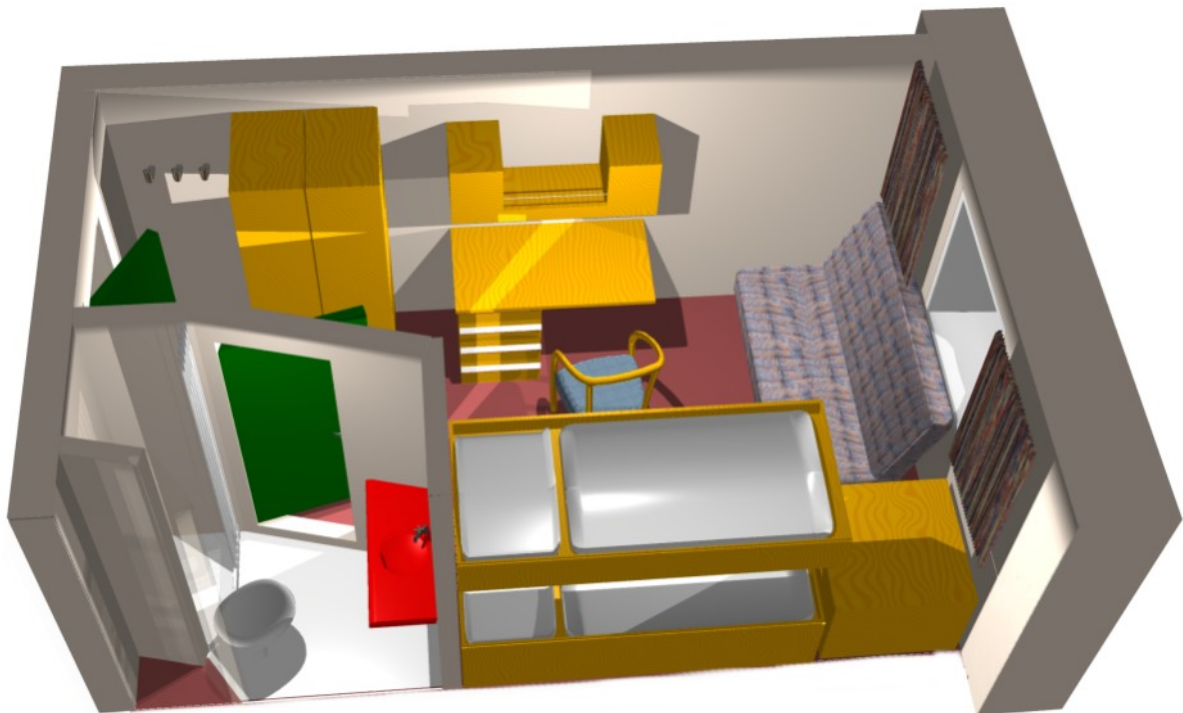

**PLEASE NOTE:** This drawing is not to scale and is intended as a general indication of the cabin layout. There may be some variation subject to deck and location. Layout is subject to change by the owner.

© 07/2007 by team-graf.at / CabinPlansKLB07.cdr / Design by Global Design - B. Graf - AUSTRIA